

WEST SUSSEX COUNTY COUNCIL
(ARUN DISTRICT) (PARKING PLACES AND TRAFFIC REGULATION)
(CONSOLIDATION) ORDER 2010
(AMENDMENT No.1 & MINOR AMENDMENT) ORDER 2010

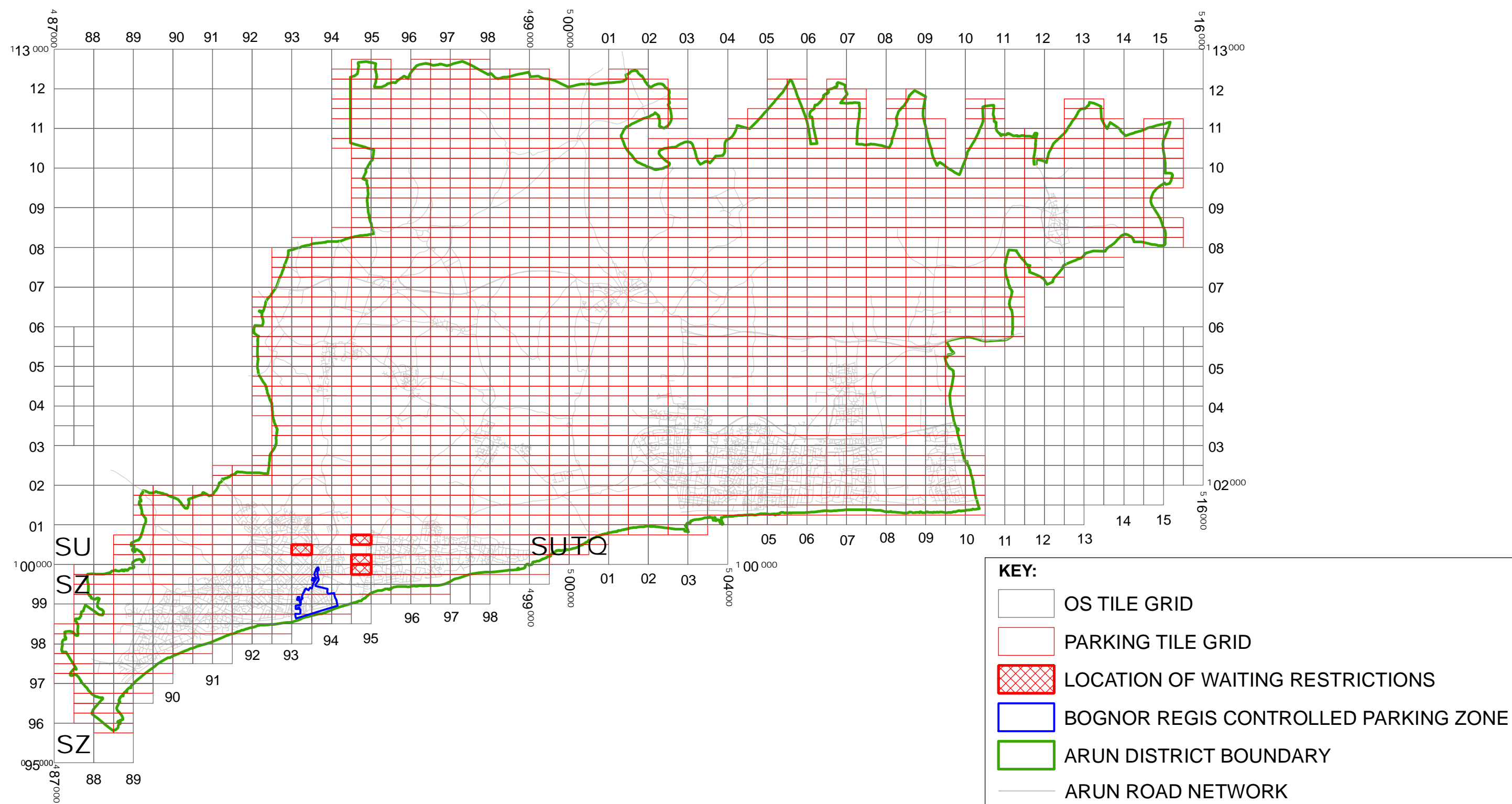

West Sussex County Council
Highways & Transport
The Grange
Tower Street
Chichester
West Sussex
PO19 1RH

WEST SUSSEX COUNTY COUNCIL
((ARUN DISTRICT) (PARKING PLACES AND TRAFFIC REGULATION)
(CONSOLIDATION) ORDER 2010)
(AMENDMENT No.1 & MINOR AMENDMENT) ORDER 2010



Reproduced from or based upon 2009 Ordnance Survey mapping with permission of the Controller of HMSO (c) Crown Copyright reserved.
Unauthorised reproduction infringes Crown copyright and may lead to prosecution or civil proceedings West Sussex County Council Licence No. 100023447

SCALE:1:100,000
DATE - 17/12/2010

Key for Waiting Restrictions

All areas over which the provision of the orders apply are defined by the shaded areas as shown on the following plans plus a contiguous area not indicated on the plans of verge and/or footway between the carriageway edge and the highway boundary. The plans in this schedule are based upon grid references of the Ordnance Survey National Grid defined by the OSGB 36 triangulation.

Prohibition of waiting

101		check	No waiting at any time	149		usgs620	No waiting 9:00am-6:00pm any day
-----	---	-------	------------------------	-----	---	---------	----------------------------------

Free Limited Waiting

708		pat038	Waiting limited to 1hr No return 1hr 9.00am-6.00pm Mon–Sat	720		usgs503	Waiting limited to 1hr No return within 2hrs 8.00am-6.00pm any day 01Apr-30Sep
-----	---	--------	--	-----	---	---------	--

Specified Vehicles

830		check	Disabled persons vehicles at any time
-----	---	-------	---------------------------------------

Clearways

1102		pat062	24hr Rural Clearway	1110		usgs667	School Keep Clear 8.00am-5.00pm Mon-Fri
------	---	--------	---------------------	------	---	---------	---

WEST SUSSEX COUNTY COUNCIL
((ARUN DISTRICT) (PARKING PLACES AND TRAFFIC REGULATION)
(CONSOLIDATION) ORDER 2010
(AMENDMENT NO. 1 & MINOR AMENDMENT) ORDER 2010

West Sussex County Council in exercise of their powers under Sections 1 (1) 2 (1) and (2), 4 (2), 45, 46, 49 and 53 and Part IV of Schedule 9 of the Road Traffic Regulation Act 1984 "the Act" as amended and of all other enabling powers and after consultation with the chief officer of police in accordance with Part III of Schedule 9 to the Act hereby make the following Order:-

1. This Order shall come into operation on the seventeenth day of December 2010 and may be cited as "West Sussex County Council ((Arun District) (Parking Places and Traffic Regulation) (Consolidation) Order 2010) (Amendment No. 1 & Minor Amendment) Order 2010."
2. The "West Sussex County Council (Arun District) (Parking Places and Traffic Regulation) (Consolidation) Order 2010" is hereby amended by the deletion from it of the plans specified in the First Schedule to this Order and the substitution of the plans attached in the Second Schedule to this Order.

FIRST SCHEDULE
Plan numbers to be revoked

SU9300SWN (Issue No. 1)
 SU9400NES (Issue No. 1)
 SU9400SES (Issue No. 1)
 SZ9499NEN (Issue No. 1)

SECOND SCHEDULE
Plans to be substituted
(as attached)

SU9300SWN (Issue No. 2)
 SU9400NES (Issue No. 2)
 SU9400SES (Issue No. 2)
 SZ9499NEN (Issue No. 2)

The COMMON SEAL of WEST SUSSEX
 COUNTY COUNCIL was hereto affixed

the THIRTIETH day of NOVEMBER 2010
 in the presence of

Authorised Signatory

)
)
)
)
) (L.S.)
)
)
)

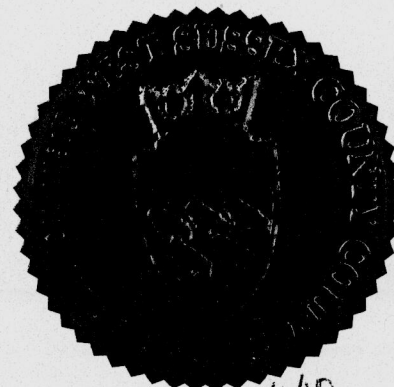

9255/6/10

04/08 DELEGATED AUTHORITY

I HEREBY CERTIFY THIS TO
 BE A TRUE COPY OF THE
 ORIGINAL DOCUMENT

Authorised Officer

WEST SUSSEX COUNTY COUNCIL

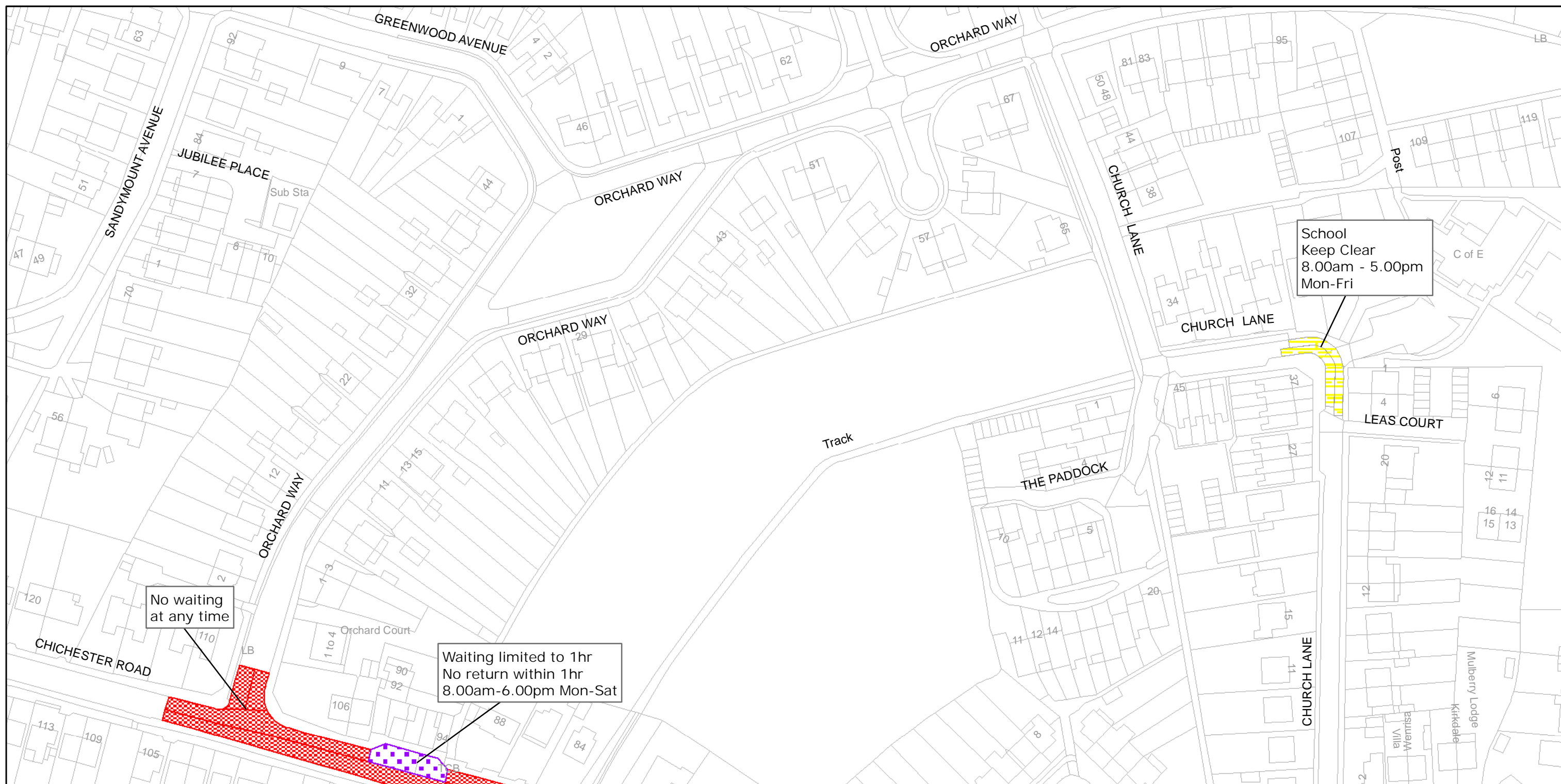

West Sussex County Council
Infrastructure
The Grange
Tower Street
Chichester
West Sussex
PO19 1RH

ARUN DISTRICT: BOGNOR REGIS

WAITING RESTRICTIONS

TILE REF NO:
SU9300SWN

SHEET ISSUE NO 2

SHEET ACTIVE FROM - 17/12/2010



SCALE:
1:1250
at A3 size

Reproduced from or based upon 2009 Ordnance Survey mapping with permission of the Controller of HMSO (c) Crown Copyright reserved.
Unauthorised reproduction infringes Crown copyright and may lead to prosecution or civil proceedings West Sussex County Council Licence No. 100023447



West Sussex County Council
Infrastructure
The Grange
Tower Street
Chichester
West Sussex
PO19 1RH

ARUN DISTRICT: FELPHAM
WAITING RESTRICTIONS

TILE REF NO:
SU9400NES

SHEET ISSUE NO 2
SHEET ACTIVE FROM - 17/12/2010

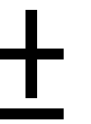

SCALE:
1:1250
at A3 size

Reproduced from or based upon 2009 Ordnance Survey mapping with permission of the Controller of HMSO (c) Crown Copyright reserved.
Unauthorised reproduction infringes Crown copyright and may lead to prosecution or civil proceedings West Sussex County Council Licence No. 100023447

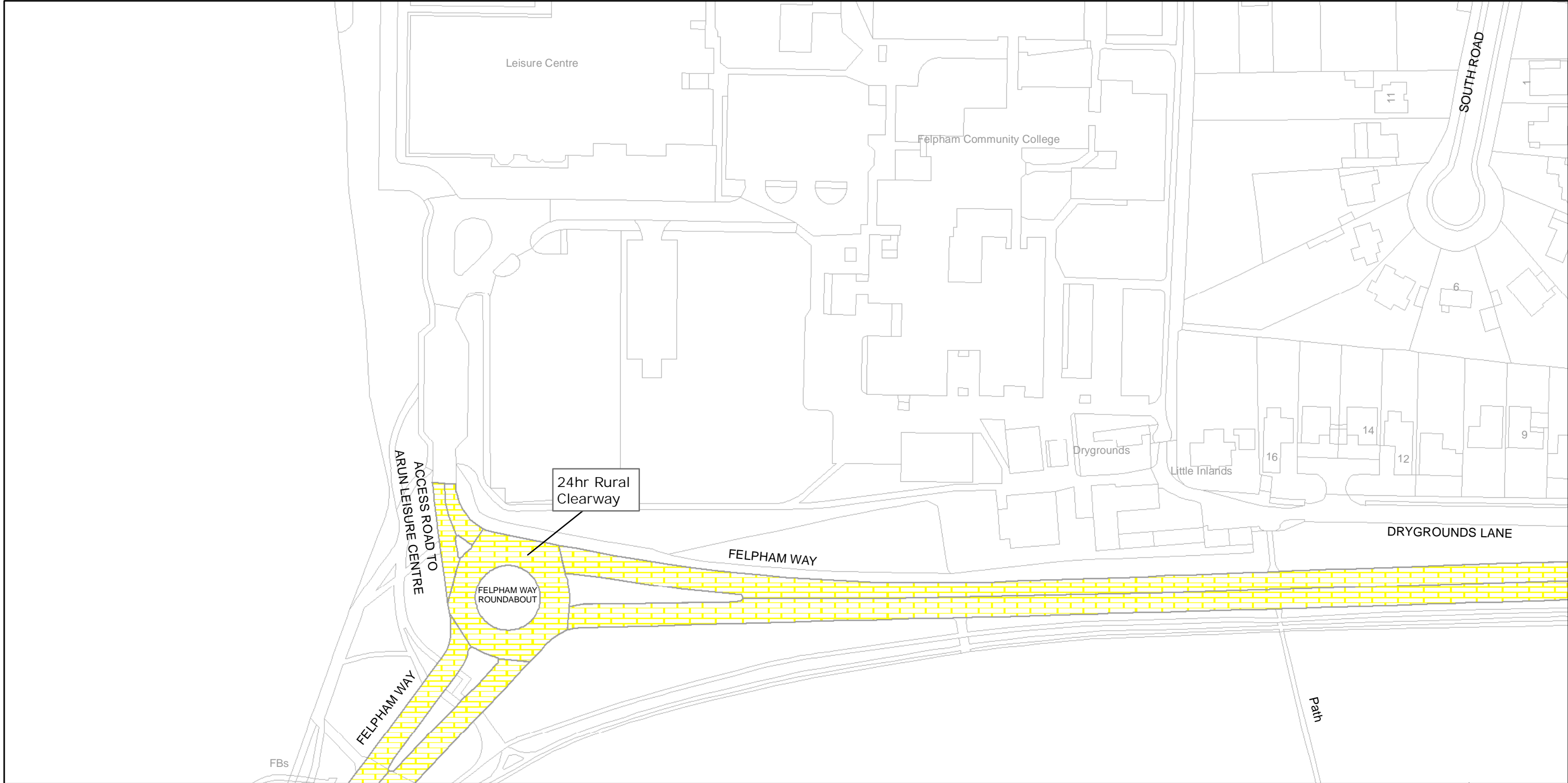

West Sussex County Council
Infrastructure
The Grange
Tower Street
Chichester
West Sussex
PO19 1RH

ARUN DISTRICT: FELPHAM
WAITING RESTRICTIONS

TILE REF NO:
SU9400SES

SHEET ISSUE NO 2
SHEET ACTIVE FROM - 17/12/2010



SCALE:
1:1250
at A3 size

Reproduced from or based upon 2009 Ordnance Survey mapping with permission of the Controller of HMSO (c) Crown Copyright reserved.
Unauthorised reproduction infringes Crown copyright and may lead to prosecution or civil proceedings West Sussex County Council Licence No. 100023447

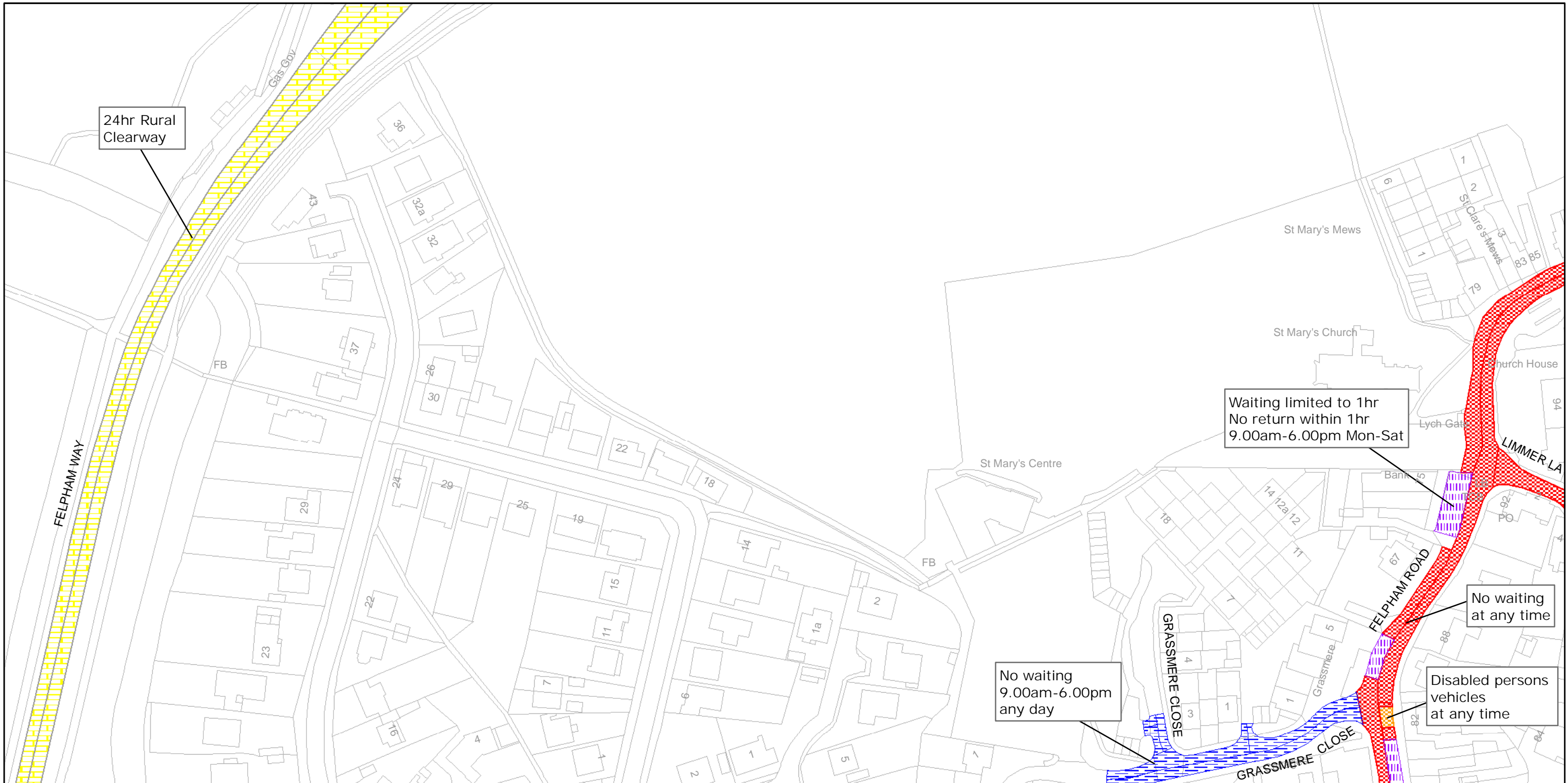

West Sussex County Council
Infrastructure
The Grange
Tower Street
Chichester
West Sussex
PO19 1RH

ARUN DISTRICT: BOGNOR REGIS AND FELPHAM WAITING RESTRICTIONS

Reproduced from or based upon 2009 Ordnance Survey mapping with permission of the Controller of HMSO (c) Crown Copyright reserved.
Unauthorised reproduction infringes Crown copyright and may lead to prosecution or civil proceedings West Sussex County Council Licence No. 100023447

TILE REF NO:
SZ9499NEN

SHEET ISSUE NO 2
SHEET ACTIVE FROM - 17/12/2010

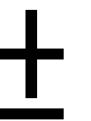

SCALE:
1:1250
at A3 size